

APPENDIX

-Basic information of Tianjin

Briefing

Tianjin is the third largest city in China.

The name "Tianjin" first came into use in 1404. It means "a port for the emperor." With an average altitude of 2-5 meters above sea level, Tianjin is the lowest city in China. The Jiushanding Mountain in the north is the highest peak in Tianjin at 1,078.5 meters above sea level.

With an area of 11,966 square kilometers (0.13% of the total Chinese territory), and a population of 13.86 million (around 1% of the national population in China), Tianjin is one of the four municipalities directly under the administration of China's central government (The other three are Beijing, Shanghai and Chongqing).

After more than 600 years of development, Tianjin is the economic and logistics center as well as a key hub of sea-land-air communications in North China. It is attracting more and more attention from the world due to its rapid development during the recent years. In 2012, the Economist Intelligence Unit named Tianjin in the list of World's Most Competitive Cities.

The area of Tianjin began to be inhabited when the Grand Canal was completed in Sui dynasty (581-618). The name of "Tianjin" first came into use in 1404 when the Emperor Yongle of Ming dynasty (1368-1644) ordered the construction of city walls and the setting up of defenses. Thus was born a city that served as a stronghold and gateway for Beijing.

Tianjin is now divided into sixteen districts: Heping, Hexi, Nankai, Hebei, Hedong, Hongqiao, Dongli, Xiqing, Jinnan, Beichen, Wuqing, Baodi, Ninghe, Jinghai, Jizhou and Binhai New Area.

Climate

Most of China experiences monsoons with cold dry winds from the north in winter and warm humid winds from the south and southeast in summer.

Tianjin has a semi-humid continental monsoon climate in the warm Temperate Zone. Tianjin features four distinct seasons with an average annual rainfall of 600 millimetres and 200 frost-free days per year. The average wind speed throughout the year is 2-4m/s.

Below is a chart which best describes the average temperature and climate in Tianjin/Beijing during the four seasons.

season	months	temperature	notes
<i>winter</i>	<i>Nov. – Mar.</i>	<i>(-)17°C – 8°C</i>	<i>snow/dry/smog</i>
<i>spring</i>	<i>Apr. – May.</i>	<i>3°C - 13°C</i>	<i>windy/dry</i>
<i>summer</i>	<i>Jun. – Aug.</i>	<i>19°C - 40°C</i>	<i>hot/rain/humid</i>
<i>fall</i>	<i>Sept. – Oct.</i>	<i>15°C - 25°C</i>	<i>fine/cool</i>

Currency

The basic money unit of RMB is the “yuan” (元), which in daily oral language is referred to as “kuai” (块). It is divided into 10 “jiao” (角) more commonly referred to as “mao” (毛). The smallest sub-division is the “fen” (分) or cent.

1 yuan (kuai) = 100 fen (cents)

1 jiao (mao) = 10 fen

Notes are issued in denominations of: ¥100, ¥50, ¥20, ¥10, ¥5, ¥1; 5 jiao, and 1 jiao. Coins are issued in six denominations. The ¥1 coin is made of polished nickel with a smooth edge. It is marked ¥1 yuan and shows the numeral 1. The 5 jiao coin is worth 50 fen or half a yuan. It is made of brass and inscribed with wu jiao and the numeral 5. There are two 1 jiao coins worth 10 fen or 1 mao. One is aluminium with the numeral 1 and the other is larger with an octagonal pattern around the edge, also made of aluminium. It is marked with the numeral 1 and yi jiao. There are coins for 5 fen, 2 fen and 1 fen.

Notes and coins are disappearing in daily life as people are using more and more e-wallet.

Electrical voltage

Electricity in China is 220 volts, 50 Hz AC. Electrical sockets come in at least four designs: three-pronged angled sockets (UK/Australia), three-pronged round sockets (Hong Kong), two-pronged flat sockets (US) and two-pronged narrow round sockets (Europe).

Conversion plugs, battery chargers, and industrial converters for larger appliances, such as computers, are easily available at IT and electric appliances shops in Tianjin. You can also buy via e-shopping.

Language

The official “common language” of China is Pǔtōnghuà (普通话) or Mandarin as it is called in English. Tianjin has its local dialect, but Pǔtōnghuà is widely used in daily work. Pinyin is the name given to the written script using Roman letters to represent the pronunciation of characters. Sounds are as they are pronounced in English but with a few exceptions:

c is pronounced ‘ts’ as in “its”

q is pronounced ‘ch’ as in “choose”

x is pronounced ‘sh’ as in “short”

z is pronounced ‘ds’ as in “bids”

zh is pronounced as the initial ‘j’

Local time

One standard time operates across all of China. Tianjin is eight hours ahead of GMT and thirteen hours ahead of EST.

Security

The crime rate in China is low, and in Tianjin it is even lower. Although crimes against expatriates are uncommon, common sense should prevail and normal precautions should be observed. Identification or a copy should be carried with you at all times.

IMPORTANT: According to the regulations from the Public Security Bureau (PSB), if a non-Chinese passport holder lives in or moves to an accommodation other than hotels or serviced accommodations, within 24 hours after arrival, he/she shall apply for a Residence Registration Card (Bèichákǎ 备查卡) at the living quarters district's PSB office. This is compulsory and not negotiable and it is a must later when applying for your residence permit or extending your visa. **E-SMART** will assist our clients with such applications.



Television

Public satellite TV programs are available in most decent hotels and serviced accommodations. Individual satellite TV system can be subscribed if you live in private accommodations. Chinese Central Television (CCTV) airs in five foreign language channels: English, Spanish, French, Arabic and Russian, with news, cultural, current affairs and general entertainment programs.



Tipping

It is not a local custom to tip although tipping is becoming a common practice at places frequented by expatriates such as restaurants, hotels, taxi service and travel service. A 10-15%

service surcharge is automatically added to your bill in hotel restaurants, so in this case tipping is not customary.

Weights and measures

China has converted to the metric system but a domestic system is also in use. For example:

weight: 1 jin = 0.5 kilogram
length: 1 li = 0.5 kilometer
area: 1 mu = 0.0667 hectare (15 mu equal to one hectare)



Artist: Edison Park (Seo Young Park)

-Chinese festivals and public holidays

Each year, there are eleven days of statutory holidays in mainland China, besides Saturdays and Sundays.

date	festival	Chinese name	holidays
January 1 st	New Year's Day	Yuándàn Jié 元旦节	one day
the last day of the last lunar month, the 1 st and 2 nd day of the first lunar month	Spring Festival (Chinese New Year)	Chūn Jié 春节	three days
April 4 th or 5 th or 6 th (the 15 th day after the Spring Equinox)	Qing Ming Festival (Tomb-sweeping Day)	Qīngmíng Jié 清明节	one day
May 1 st	Labor's Day	Láodòng Jié 劳动节	one day
the 5 th day of the fifth lunar month	Duan Wu Festival (Dragon Boat Festival)	Duānwǔ Jié 端午节	one day
the 15 th day of the eighth lunar month	Mid-Autumn Festival (Moon Cake Festival)	Zhōngqiū Jié 中秋节	one day
October 1 st , 2 nd , 3 rd	National Day	Guóqìng Jié 国庆节	three days



Artist: Remy Zhu (朱梓墨)



Artist: Wang Yanbin (王彦彬)

The most important Chinese festival is “Spring Festival” which is also called “Chinese Lunar New Year”. It is similar to Christmas in its importance. Every year the date of Chinese Lunar New Year falls between the end of January and early February according to Chinese lunar calendar, as the lunar calendar month is usually around one month later than the Gregorian calendar month. It is a celebration with many great banquets and may last for more than 15 days. Fireworks and firecrackers have been forbidden in Tianjin since 2018.

By working extra on the weekends before or after Spring Festival and National Day, the working class can enjoy two full weeks of holidays per year, which is called “Golden Week”.

Most restaurants and shops remain open during these holidays. This is the golden business season for entertainment, retail and transportation service.

Chinese people also celebrate the following traditional festivals, although they are not statutory holidays yet.

date	festival	Chinese name
the 15 th day of the first lunar month	Yuanxiao Festival/ Lantern Festival	Yuánxiāo Jié/Shàngyuán Jié 元宵节/上元节
the 7 th day of the seventh lunar month	Double-Seventh Day/ Chinese Valentine's Day/ Skill Acquisition Festival/ Girls Festival	Qīxī Jié/Quèqiáo Huì/ Qīqiǎo Jié/Nǚ'ér Jié 七夕节/鹊桥会/ 乞巧节/女儿节
the 9 th day of the ninth lunar month	Chongyang Festival/ Double Ninth Festival	Chóngyáng Jié/ Lǎorén Jié 重阳节/老人节
December 21 st or 22 nd or 23 rd	Dongzhi Festival	Dōngzhì Jié/Dōng Jié 冬至节/冬节
the 8 th day of the twelveth lunar month	Laba Festival	Làbā Jié 腊八节



Artist: Tang Yi (唐怡)

-How to apply for the Dog Registration Certificate

As stipulated in the law of the People's Republic of China on the Entry-Exit Animal and Plant Quarantine, each expat is allowed to bring one dog when entering China. The dog bearer shall provide a valid immunization record file and a valid vaccination certificate issued by an official animal quarantine agency of the region or the country where the dog comes from.

Tianjin Inspection and Quarantine Institution shall examine the dog at the Customs. The dog that can pass the examination shall be kept in quarantine for 30 days at an appointed place.

A dog keeper shall apply for an annual **Dog Registration Certificate** and have it renewed each year.

1. Dog can/can't obtain Registration Certificate
 - (1) Miniature ornamental dog can get the certificate if he/she is lower than 45cm in height. (Such as Pekingese, Pomeranian, Chihuahua, Pug, Papillon, etc.)
 - (2) Ferocious dog can't get the certificate. (Such as Mastiff, German Doberman, Saint Bernard, Great Dane, Great Pyrenees, etc.)
2. The following documents are needed:
 - (1) Passport of the dog keeper and the copy of passport
 - (2) Residence Registration Card
 - (3) Proof of an independent accommodation, such as a lease agreement
 - (4) Copy of the leased property's ownership certificate
 - (5) Dog immunization record file
 - (6) 2 pieces of 2-inch colour photographs of the dog
 - (7) Entrust Letter to your agent is required if the application can't be handled in person

The documents' requirement may have small difference, please contact your living quarter district before going for application.

3. Official Account of “天津犬管” (tiānjīnquǎnguǎn) is available for this application of your Dog Certificate either.

4. Contact numbers of Pet Certification Offices

district	telephone number
Heping	58929215
Hexi	23249800
Nankai	27419428
Hedong	24162218
Hongqiao	26370051
Jinnan	88637866
Wuqing	82132265
Binhai New Area	65270570



-How to apply for the local Driving License

A Chinese Local Driving License can be obtained either by attending a local driver's training school and passing the examinations or by applying in the same Chinese city where your Residence Permit is issued, using your driving license from another country.

The application procedures are:

1. Verify your foreign driver's license is acceptable.

Please bring your following documents to Tianjin TMB Vehicle Administration Office to verify your foreign driving license is accepted.

- Original Passport,
- Residence Registration Card (Bèichákǎ 备查卡)
- Original foreign driving license

If your driving license can't be verified by Tianjin TMB Vehicle Administration Office, you will need to provide a certification from your embassy.

Tianjin Traffic Management Bureau (TMB) Vehicle Administration Office

Tiānjīn Shì Gōng'ān Jiāotōng Guǎnlǐjú Chēliàng Guǎnlǐsuǒ
天津市公安交通管理局车辆管理所

Add: Near the cross of Zhenli Dao and Jingjiang Lu, Hebei Dist.

Héběi Qū Zhēnlǐ Dào yǔ Jìngjiāng Lù jiāokǒu fùjìn

河北区真理道与靖江路交口附近

Tel: 26021615

Hours: Mon-Fri: 08:30-17:00

2. Translation of the foreign driving license:

(1) Documents needed: original passport and driving license

(2) What needs to be translated:

the front & back page of the foreign driving license. AT (Automatic Transmission) or MT (Manual Transmission) shall be indicated

(3) Requirement: to be translated and certified by an authorized translation company

(4) Time needed: one day

(5) Translation service company for reference:

Tianjin Tian Wai Translation Co., Ltd.

Tiānjīn Shì Tiān Wài Fānyì Yǒuxiàn Gōngsī

天津市天外翻译有限公司

Add: 6th Floor, Zhongfu Building, cross of Youyi Beilu and Shaoxing Dao, Hexi Dist.

Héxī Qū Yǒuyì Běilù yǔ Shàoxīng Dào jiāokǒu Zhōngfú Dàshà 6 lóu

河西区友谊北路与绍兴道交口中孚大厦 6 楼

Tel: 23240847

Hours: Mon-Fri: 08:30-17:30

e-mail: tianwaitrans@126.com

Charges for reference: RMB 200-520/set

3. Physical examination:

- (1) Documents needed: the original passport, the foreign driving license, application form for physical examination with Chinese name, one set of translation documents listed in Clause 1
- (2) Physical examination items: height, eyesight, etc. (no special requirement)
- (3) Time needed: around 10 minutes and the report is immediately available
- (4) Physical examination hospital for reference: (nearest one to the TMB Vehicle Administration Office)

Tianjin Third Central Hospital Branch Physical Examination Center

Tiānjīn Shì Dì-sān Zhōngxīn Yīyuàn fēnyuàn

天津市第三中心医院分院

Add: No. 24, Jiangdu Lu, Hebei Dist.

Héběi Qū Jiāngdū Lù 24 hào

河北区江都路 24 号

Tel: 24155888

Hours: 08:00-11:30, 13:30-16:30

Charges for reference: RMB 45

4. Application at Tianjin TMB Vehicle Administration Office:

- (1) Documents needed:
 - Translation of the foreign driving license
 - The physical examination report
 - Residence Registration Card (Bèichákǎ 备查卡)
 - Original and a photo copy of:
 - .Driving License
 - . Passport front cover page
 - . 3 copies of 1-inch colour photographs with white background (There is a photograph taking service on site charging RMB 15/set.)
- (2) Present all the documents at the reception counter in the License Application Hall
- (3) Pay the driving license examination fee RMB 50 at the reception counter after the application is accepted

5. Making an examination appointment at the License Application Hall

The examination venue is:

Subject One Examination Building (Building 2)

Kēmù Kǎoshì (1) Dàlóu (2 hào lóu)

科目考试（一）大楼(2号楼)

Tel: 26020087

6. Taking the examination:
 - (1) Tuesdays and Fridays are examination days, 08:30-11:00, 13:30-15:00 (Except for national holidays)
 - (2) 45 minutes, 100 questions online examination (in English, German, French and Spanish) on a computer. Passing scores above 90 is needed.
 - (3) If passed, submit the examination report card and all the documents listed in Clause at the reception counter in the License Application Hall
 - (4) If failed, another appointment can be made to re-sit for the examination, there is no limit to the number of tries
7. To collect the local driving license
 - (1) You can collect (no need in person) the local driving license once you receive the Collection Notice
 - (2) Fee: RMB 10
 - (3) Time needed: one day. Once you pass the required examination, the license will be issued immediately

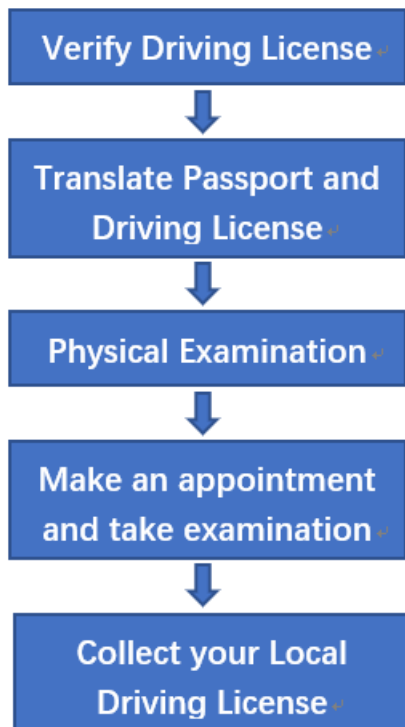

-How to pay for the utility fees

E-SMART consultants will provide detail guidance to each client regarding utility payment upon check-in. The following information is for your reference only.

Electricity

Service hotline for Tianjin City: 95598

Service hotline for TEDA: 25202526

Electricity charges are prepaid. Both the electricity IC card and the paper certificate are necessary when processing the pre-payment at the branch shops of the State Grid listed below.

Pre-payment can also be dealt online via Alipay and WeChat. E-SMART staff can assist you in setting this up.

From July 1, 2012, a tiered electricity pricing structure has been implemented with a household smart electricity meter.

<i>annual consumption (KW/H)</i>	<i>unit price (RMB)</i>
≤ 2640	0.49
2641~4800	0.54
≥ 4801	0.79

NOTICE: When there is less than RMB 10 of electricity left in the meter, the power supply will be cut off, as a reminder. When this happens, insert the IC card and it will re-start the power supply. Pre-payment for electricity should be purchased ASAP.

Branch shops in Tianjin City

Downtown area

State Grid - Heping Branch

Tiānjīn Diànlì Gōngsī Héping Yíngyètīng

天津电力公司和平营业厅

Add: Cross of Xizang Lu and Wanquan Dao, Heping Dist.

Héping Qū Xīzàng Lù yǔ Wànquán Dào jiāokǒu

和平区西藏路与万全道交口

Tel: 27319905

Hours: Mon-Fri: 08:30-17:00

Sat-Sun: 09:00-16:30

Water Park area

State Grid - Nankai Branch

Tiānjīn Diànlì Gōngsī Nánkāi Gōngdiàn Yíngyètīng

天津电力公司南开供电营业厅

Add: 1st Floor, Building 6, Saide Plaza, No. 278, Hongqi Lu, Nankai Dist. (Infection Diseases Hospital)

Nánkāi Qū Hóngqí Lù 278 hào Sàidé Guǎngchǎng 6 hào lóu 1 lóu (Chuánrǎnbìng
Yīyuàn duìmiàn)

南开区红旗路 278 号赛德广场 6 号楼 1 楼（传染病医院对面）

Tel: 27626423

Hours: Mon-Fri: 08:30-17:00

Sat-Sun: 09:00-16:30

Meijiang area and Original County

State Grid - Hexi Branch

Tiānjīn Diànlì Gōngsī Héxī Yíngyètīng

天津电力公司河西营业厅

Add: No. 68, Heiniucheng Dao, Hexi Dist.

Héxī Qū Hēiniúchéng Dào 68 hào

河西区黑牛城道 68 号

Tel: 28353056

Hours: Mon-Fri: 08:30-17:00

Sat-Sun: 09:00-16:30

State Grid - Jinnan Shuanggang Branch

Tiānjīn Diànlì Gōngsī Jīnnán Shuānggǎng Yíngyètīng

天津电力公司津南双港营业厅

Add: Next to Jiulong Jie Clinic, Shuanggang Town, Jinnan Dist.

Jīnnán Qū Shuānggǎng Zhèn Jiǔlóng Jiē Wèishēngyuàn páng

津南区双港镇九龙街卫生院旁

Tel: 28580132

Hours: Mon-Fri: 08:30-17:00

Sat-Sun: 09:00-16:30

Branch shops in TEDA

State Grid - TEDA Branch

Tiānjīn Diànlì Gōngsī Tàidá Gōngdiàn Yíngyètīng

天津电力公司泰达供电营业厅

Add: Cross of The 2nd Ave. and Tengfei Lu, TEDA

Tiānjīn Jīngjì Jìshù kāifāqū Dì-2 Dàjiē yǔ Téngfēi Lù jiāokǒu

天津经济技术开发区第二大街与腾飞路交口

Tel: 66251012

Hours: Mon-Fri: 08:30-12:00, 13:00-16:30

Sat-Sun: 09:30-12:00, 13:30-16:00

TEDA Management Committee

Tiānjīn Jīngjì Jìshù Kāifāqū Guǎnwěihui

天津经济技术开发区管委会

Add: Holding Hall, Section B, 1st Floor, TEDA Management Committee, No. 19, Hongda Jie,
TEDA

Tiānjīn Jīngjì Jìshù Kāifāqū Hóngdá Jiē 19 hào kāifāqū guǎnwěihui 1 lóu B qū

kònggǔtīng

天津经济技术开发区宏达街 19 号开发区管委会 1 楼 B 区控股厅

Tel: 25202535, 25202527

Hours: Mon-Fri: 09:00-12:00, 13:30-17:00

Gas

Service hotline for Tianjin City: 23006777

Service hotline for TEDA: 25326936

Most gas meters use a pre-payment system. Both the gas IC card and the paper certificate are necessary when processing the prepayment. The gas shops are listed below.

From November 1, 2015, a tiered gas pricing structure has been implemented with a household smart gas meter.

<i>annual consumption (M³)</i>	<i>unit price (RMB)</i>
≤300	2.5
301-600	3
≥ 601	3.75

NOTICE: Prepaid. When there is less than 10M³ of gas left, “Di, Di...” sound will beep in the meter. When there is less than 1.9M³ of gas left, the power supply will be cut for reminding; At this time, to insert the IC card can re-start the power supply. But more gas should be purchased ASAP.

Branch shops in Tianjin City

Downtown area

Tianjin Gas Group - Heping Branch

Tiānjīn Shì Ránqì Jítuán Héping Yíngyètīng

天津市燃气集团和平营业厅

Add: No. 66, Yichang Dao, Heping Dist.

Héping Qū Yíchāng Dào 66 hào

和平区宜昌道 66 号

Tel: 23379579

Hours: Mon-Sun: 08:30-20:00

Water Park area

Tianjin Gas Group - Huayuan Branch

Tiānjīn Shì Ránqì Jítuán Huáyuan Yíngyètīng

天津市燃气集团华苑营业厅

Add: Next to building 21, Changhuali, Yashi Dao, Huayuan, Nankai Dist. (beside the railway)

Nánkāi Qū Huáyuan Yǎshì Dào Chánghuáli 21 hào lóu páng (tiědào páng)

南开区华苑雅士道长华里 21 号楼旁 (铁道旁)

Tel: 23726545

Hours: Mon-Sun: 08:30-17:00

Meijiang area and Original County

Tianjin Gas Group - Hexi Branch

Tiānjīn Shì Ránqì Jítuán Héxī Yíngyètīng

天津市燃气集团河西营业厅

Add: Commercial Section, No. 6, Shuyuanli, Nanbei Dajie, Tucheng, Hexi Dist.

Héxī Qū Tǔchéng Nánběi Dàjiē Shūyuànli Dǐshāng 6 hào

河西区土城南北大街书苑里底商 6 号

Tel: 28229998

Hours: Mon-Sun: 08:30-20:00

Tianjin Gas Group - Tianlian Co., Ltd.

Tiānjīn Shì Ránqì Jítuán Tiānlián Gōngsī

天津市燃气集团天联公司

Add: No. 5, Chilong Jie, Jinnan Economic Development Area

Jīnnán Kāifāqū Chìlóng Jiē 5 hào

津南开发区赤龙街 5 号

Tel: 28187475

Hours: Mon-Sun: 08:30-20:00



Artist: Edison Park (Seo Young Park)

Branch shops in TEDA

TEDA Management Committee

Tiānjīn Jīngjì Jìshù Kāifāqū Guǎnwěihui

天津经济技术开发区管委会

Add: Holding Hall, Section B, 1st Floor, TEDA Management Committee, No. 19, Hongda Jie, TEDA

Tiānjīn Jīngjì Jìshù Kāifāqū Hóngdá Jiē 19 hào kāifāqū Guǎnwěihui 1 lóu B qū kònggǔtīng

天津经济技术开发区宏达街 19 号开发区管委会 1 楼 B 区控股厅

Tel: 25202535, 25202527

Hours: Mon-Fri: 09:00-12:00,13:30-17:00

Tianjin Gas Group - TEDA Branch

Tiānjīn Shì Ránqì Jítuán Tàidá Yíngyètīng

天津市燃气集团泰达营业厅

Add: The 2nd Ave., TEDA (west of Renaissance TEDA Hotel)

Tiānjīn Jīngjì Jìshù Kāifāqū Dì-2 Dàjiē (Tàidá Wànlì Jiǔdiàn xīcè)

天津经济技术开发区第二大街（泰达万丽酒店西侧）

Tel: 400-081-7668, 66216377, 25293657
Hours: Mon-Fri: 08:30-12:00, 13:00-16:30
Sat-Sun: 09:00-16:00

Water

Service hotline for Tianjin City: 96655

Service hotline for TEDA: 66200001

There are at present three types of water meters in Tianjin: pre-pay IC card meter, pay-after-use smart water meter, and manual check water meter.

From November 1, 2015, a tiered water pricing structure has been implemented with a household smart water meter.

<i>annual consumption (Ton)</i>	<i>unit price (RMB)</i>
≤ 180	4.9
181-240	6.2
≥ 241	8.0

NOTICE: For the pre-pay IC card user, when there is less than 2 tons of water left in the meter, the water supply will be cut off, as a reminder. When this happens, insert the IC card and it will restart the water supply. Pre-payment for water should be purchased ASAP. Both the water IC card and the paper certificate are necessary when purchasing water.

For the pay-after-use smart meter user, the water company sends a bill to the landlord's mobile phone every other month. If the fee is not paid within four months after getting the bill, the water supply will be cut off.

For the manual check meter user, the fee is paid face to face, in cash, by WeChat or Alipay, when the water company staff comes every other month.

Tianjin will replace all the water meters with smart meters in the near future.

1.How to pay for water account by WeChat

(1) How to bind an account?

NOTICE: If the water meter in your apartment has been changed to a smart meter, you can pay the water bill by WeChat. Firstly, you should copy Chinese character “天津市自来水集团有限公司” for **Step 2**. In addition, you should also get your account ID for **Step 6**, which is a 12-digit number.

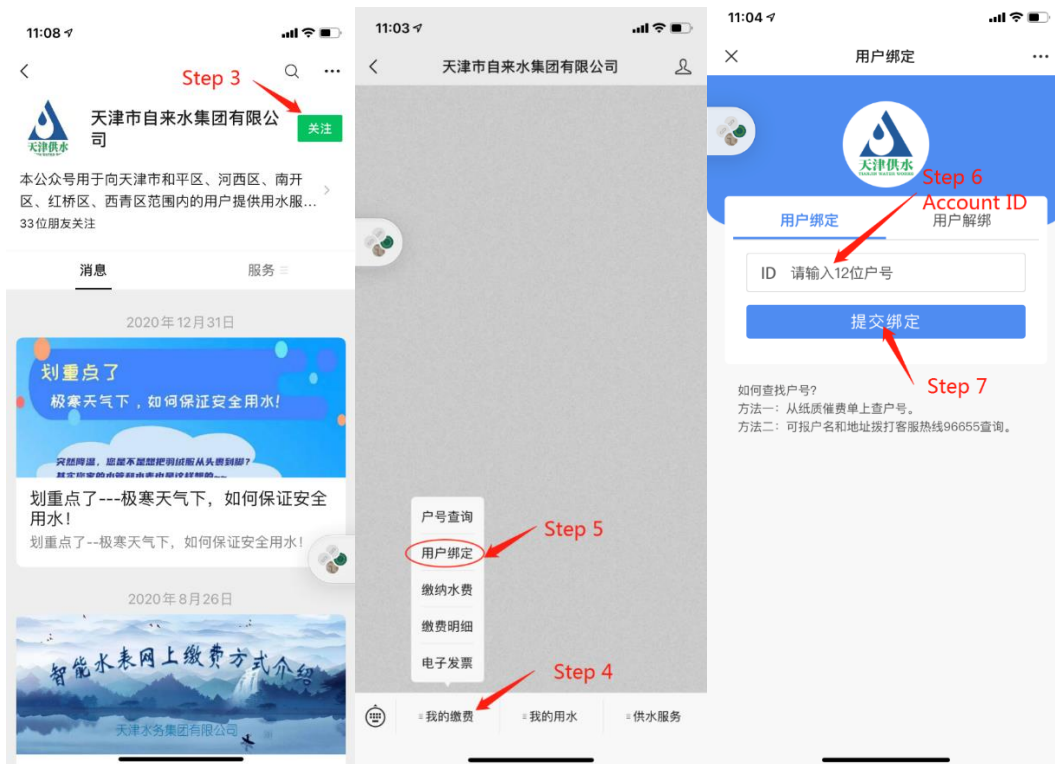

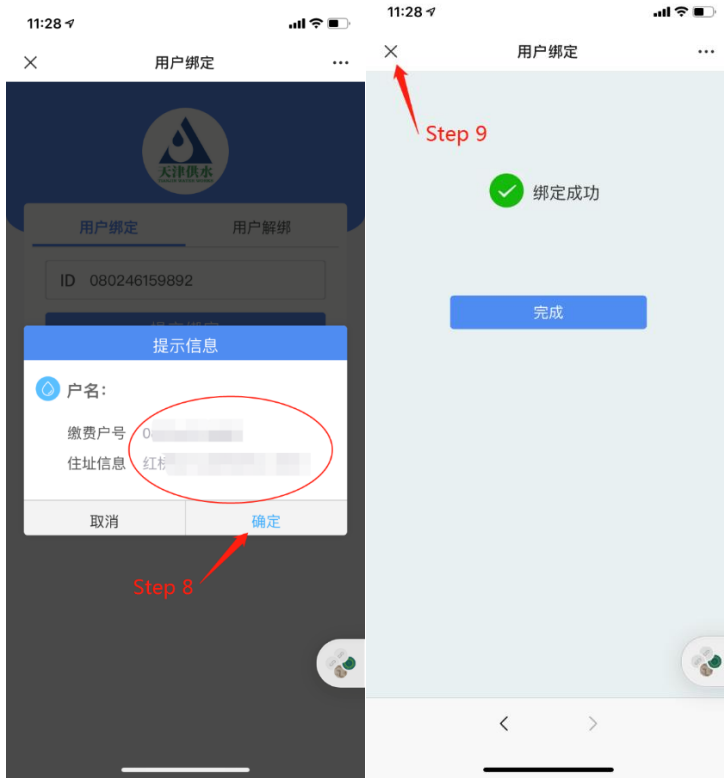

(2) How to put money into an account?

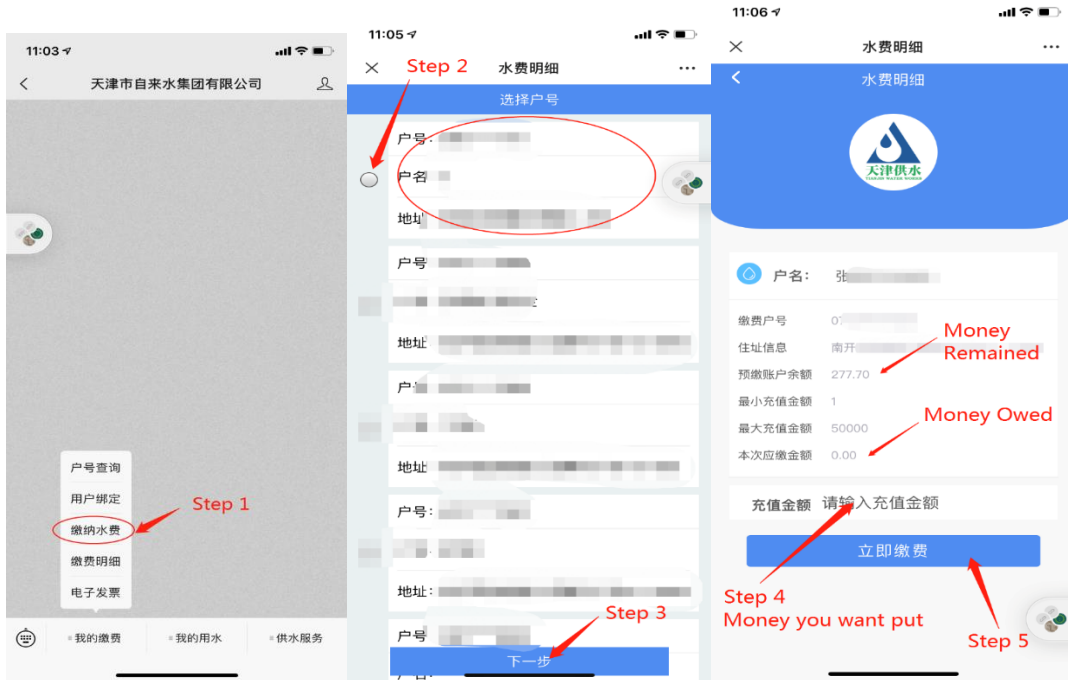

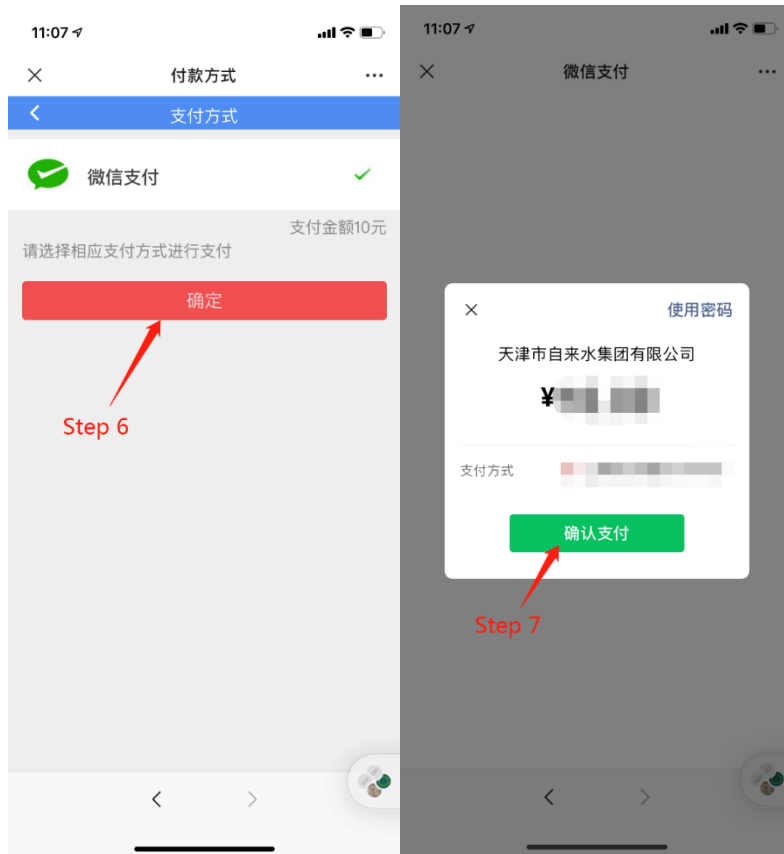

The water shops are listed below:

2. Branch shops in Tianjin City

Downtown area

Tianjin Water Supply Company -Hexi Branch

Tiānjīn Zìláishuǐ Gōngsī Héxī Yíngyètīng

天津自来水公司河西营业厅

Add: No. 175, Shaoxing Dao, Hexi Dist. (Commercial Section, Shengrui Apartment)

Héxī Qū ShàoXīng Dào 175 hào (Shèngruì Gōngyù Dǐshāng)

河西区绍兴道 175 号 (盛瑞公寓底商)

Tel: 23262695

Hours: Mon-Fri: 08:30-18:30

Sat-Sun: 08:30-17:00

Water Park area

Tianjin Water Supply Company – Nankai Ling Ao Lu Branch

Tiānjīn Zìláishuǐ Gōngsī Nánkāi Líng'ào Lù Yíngyètīng

天津自来水公司南开凌奥路营业厅

Add: No. 2, cross of Hongqi Nanlu and Lingbin Lu, Nankai Dist.

Nánkāi Qū Hóngqí Nánlù yǔ Língbīn Lù jiāokǒu 2 hào

南开区红旗南路与凌宾路交口 2 号

Tel: 88377065

Hours: Mon-Fri: 08:30-18:30

Sat-Sun: 09:00-17:00

Meijiang area and Original County

Tianjin Water Supply Company -Meijiang Branch

Tiānjīn Zìláishuǐ Gōngsī Méijiāng Yíngyètīng

天津自来水公司梅江营业厅

Add: Commercial Section, Building 3, Tianlanyuan, Huandao Xilu, Meijiang Residential Area, Hexi Dist.

Héxī Qū Méijiāng Jūzhùqū Huándǎo Xīlù Tiānlányuán 3 hào lóu Dīshāng
河西区梅江居住区环岛西路天澜园 3 号楼底商

Tel: 88162310

Hours: Mon-Fri: 08:30-18:30

Sat-Sun: 08:30-17:00

Tianjin Water Supply Company -Shuanggang Xinjiayuan Branch

Tiānjīn Zìláishuǐ Gōngsī Shuānggǎng Xīnjiāyuán Yíngyètīng

天津自来水公司双港新家园营业厅

Add: Cross of Jingang Express Way and Lishuang Lu, Jinnan Dist.

Jīnnán Qū Jīngǎng Gāosù yǔ Líshuāng Lù jiāokǒu
津南区津港高速与梨双路交口

Tel: 88828930

Hours: Mon-Fri: 08:00-17:00

Sat-Sun: 08:00-12:00, 13:30-17:00

Branch shops in TEDA

TEDA Management Committee

Tiānjīn Jīngjì Jìshù Kāifāqū Guǎnwěihuì

天津经济技术开发区管委会

Add: Holding Hall, Section B, 1st Floor, TEDA Management Committee, No. 19, Hongda Jie, TEDA

Tiānjīn Jīngjì Jìshù Kāifāqū Hóngdá Jiē 19 hào kāifāqū guǎnwěihuì 1 lóu B qū kònggǔtīng

天津经济技术开发区宏达街 19 号开发区管委会 1 楼 B 区控股厅

Tel: 25202535, 25202527

Hours: Mon-Fri: 09:00-12:00, 13:30-17:00

TEDA Water Supply Company

Tàidá Zìláishuǐ Gōngsī

泰达自来水公司

Add: Commercial Section, Dongfang Mingju, The 2nd Ave., TEDA

Tiānjīn Jīngjì Jìshù Kāifāqū Dì-2 Dàjiē Dōngfāng Míngjū Dīshāng
天津经济技术开发区第二大街东方名居底商

Tel: 25329837

Hours: Mon-Fri: 08:30-16:30

Sat-Sun: 09:00-12:00, 13:00-16:00



Phone

You can either keep a credit balance on your mobile phone account or remember to pay the bill every month on line or at the branch shops of the three different telecommunication service providers, at a post office, or at a bank. The telecommunication branch shops are listed below.

NOTICE: The phone service would be terminated if the bill is overdue for a certain amount. The Internet access will be affected if it is bound together with your mobile phone.

service provider	service hotline	business scope(s)	segment numbers
<i>China Mobile</i>	<i>10086</i>	- <i>mobile phone</i> - <i>home phone and internet</i>	<i>135~139, 150~152, 157-159, 178, 182, 184, 187, 188, 195004, 195823, 195828 and 195829</i>
<i>China Telecom</i>	<i>10000</i>	- <i>mobile phone (CDMA)</i> - <i>home phone and internet</i>	<i>133, 153, 173, 177, 180, 181, 189, 191 and 199</i>
<i>China Unicom</i>	<i>10010</i>	- <i>mobile phone</i> - <i>home phone and internet</i>	<i>130~132, 155, 156, 166, 175, 176, 185 and 186</i>

China Mobile

Zhōngguó Yí dòng

中国移动

Service hotline: 10086

Branch shops in Tianjin City

Downtown area

Add: 1st Floor, No. 235, Nanjing Lu, Heping Dist.

Hé píng Qū Nán jīng Lù 235 hào 1 lóu

和平区南京路235号1楼

Hours: Mon-Sun: 08:30-18:00

Water Park area

Add: No. 9, Section B, Aocheng Commercial Plaza, Binshui Xidao, Nankai Dist.

Nánkāi Qū Bīnshuǐ Xīdào Àochéng Shāngyè Guǎngchǎng B qū 9 hào

南开区宾水西道奥城商业广场B区9号

Hours: Mon-Sun: 08:30-18:00

Meijiang area and Original County

Add: No. 47-13-14, Commercial Section, The Sixth Hill, Jiefang Nanlu, Hexi Dist. (beside Mcdonald's)

Héxī Qū Jiěfàng Nánlù Dì-6 Tiányuán Dǐshāng 47-13-14 hào (Màidāngláo páng)

河西区解放南路第六田园底商47-13-14号(麦当劳旁)

Hours: Mon-Sun: 08:30-18:00

Branch shop in TEDA

Add: East Area, Financial Street, No. 20, Guangchang Donglu, The 3rd Ave., TEDA

Tiānjīn Jīngjì Jìshù Kāifāqū Dì-3 Dàjiē Guǎngchǎng Dōnglù 20 hào Jīnróng Jiē Dōngqū

天津经济技术开发区第三大街广场东路20号金融街东区

Hours: Mon-Sun: 08:30-18:00

China Telecom

Zhōngguó Diànxìn

中国电信

Service hotline: 10000

Branch shops in Tianjin City

Downtown area

(1) Add: No. 217, Chengdu Dao, Heping Dist.

Héping Qū Chéngdū Dào 217 hào

和平区成都道217号

(2) Add: No. 35, Baoding Dao, Heping Dist.

Héping Qū Bǎodìng Dào 35 hào

和平区保定道35号

Hours: Mon-Sun: 08:30-18:30

Water Park area

Add: A4-2, Aocheng Commercial Plaza, Binshui Xidao, Nankai Dist.

Nánkāi Qū Bīnshuǐ Xīdào Àochéng Shāngyè Guǎngchǎng A4-2

南开区宾水西道奥城商业广场A4-2

Hours: Mon-Sun: 09:00-19:00

Meijiang area and Original County

Add: Commercial Section, Building 11-12, Lianshuiyuan, cross of Youyi Nanlu and Zhujiang Dao, Hexi Dist.

Héxī Qū Yǒuyì Nánlù yǔ Zhūjiāng Dào jiāokǒu Liánshuǐyuán 11-12 hào lóu dǐshāng

河西区友谊南路与珠江道交口涟水园 11-12 号楼底商
Hours: Mon-Sun: 09:30-19:30

Branch shop in TEDA

Add: 1st Floor, Building E5C2, East Area, Financial Street, No. 20, Guangchang Donglu, The
3rd Ave., TEDA
Tiānjīn Jīngjì Jìshù Kāifāqū Dì-3 Dàjiē Guǎngchǎng Dōnglù 20 hào Jīnróng Jiē Dōngqū
E5C2 zuò 1 lóu
天津经济技术开发区第三大街广场东路 20 号金融街东区 E5C2 座 1 楼
Hours: Mon-Sun: 08:30-18:00

China Unicom

Zhōngguó Liántōng
中国联通
Service hotline: 10010

Branch shops in Tianjin City

Downtown area

Add: No. 62, Chifeng Dao, Heping Dist.
Héping Qū Chífēng Dào 62 hào
和平区赤峰道 62 号
Hours: Mon-Sun: 09:00-18:00

Water Park area

Add: Commercial Section, Aoxiangyuan, No. 150, Weijin Nanlu, Nankai Dist.
Nánkāi Qū Wèijīn Nánlù 150 hào Àoxiángyuán Dīshāng
南开区卫津南路 150 号奥翔园底商
Hours: Mon-Sun: 08:30-17:30

Meijiang area and Original County

(1) Add: No. 101, Meijiang Dao, Hexi Dist. (opposite to Security Bureau)
Héxī Qū Méijiāng Dào 101 (Ānquánjú duìmian)
河西区梅江道 101 号 (安全局对面)
Hours: Mon-Sun: 09:00-18:00

(2) Add: Opposite Haihe Hospital, Shuanggang Town, Jinnan Dist.
Jīnnán Qū shuānggǎng Zhèn Hǎihé Yīyuàn duìmian
津南区双港镇海河医院对面
Hours: Mon-Sun: 08:30-17:30

Branch shop in TEDA

Add: Cross of Xincheng Donglu and Shengda Jie, TEDA (behind TEDA International
Cardiovascular Hospital)
Tiānjīn Jīngjì Jìshù Kāifāqū Xīnchéng Dōnglù yǔ Shèngdá Jiē jiāokǒu (Tàidá Guójì

Xīn-xuèguǎnbìng Yīyuàn hòumian)

天津经济技术开发区新城东路与盛达街交口（泰达国际心血管病医院后面）

Hours: Mon-Sun: 08:30-17:30



Artist: Edison Park (Seo Young Park)

-Useful telephone numbers

E-SMART Relocation Consultants Co., Ltd.	28360997, 13902119790
clinic and hospitals:	
Raffles Medical Tianjin Clinic	23520143
Tianjin United Family Hospital	58568500, 4008-919191
schools:	
International School of Tianjin (IST)	28592001
TEDA Global Academy	66226158
Tianjin International School (TIS)	83710900
Wellington College International Tianjin	87587199
emergency:	
ambulance	120 Chinese speaker
fire	119
police	110



项目类型: JPG 文
分辨率: 1279 x 1



Artist: Nassrin Afnan(那文丽)